

Shark[®]

Cordless Handheld Vacuum

BH102UK

OWNER'S GUIDE

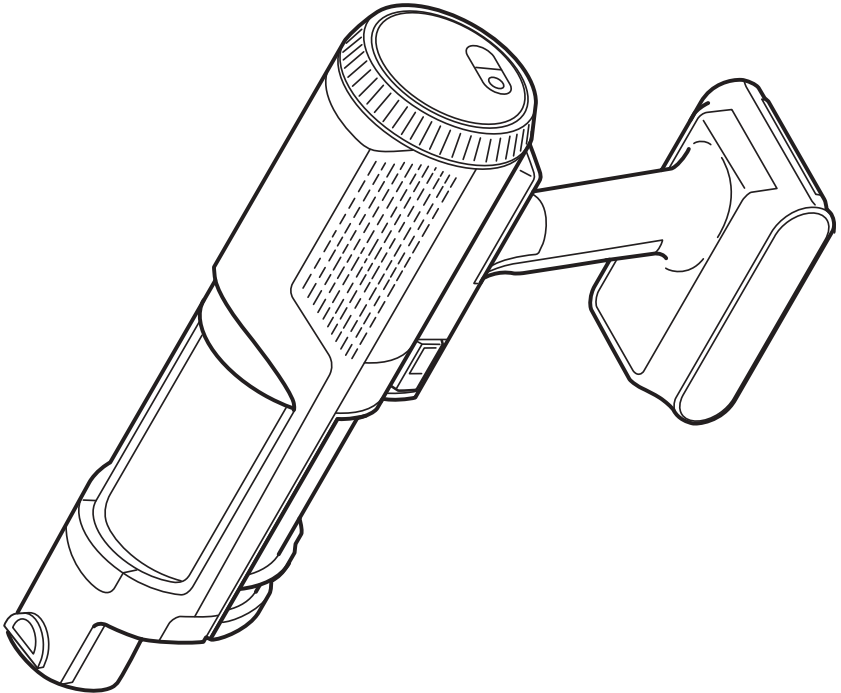

IMPORTANT SAFETY INSTRUCTIONS

FOR HOUSEHOLD USE ONLY

⚠ WARNING

When using an electrical appliance, to reduce the risk of fire, electric shock, injury, or property damage, basic precautions should always be followed, including the following:

READ ALL INSTRUCTIONS BEFORE USING THIS VACUUM:

1. This unit is a motorized handheld vacuum. These components contain electric connections, electrical wiring, and moving parts that potentially present risk to the user.
2. Before each use, carefully inspect all parts for any damage. If a part is damaged, discontinue use.
3. Use only identical replacement parts.
4. This vacuum contains no serviceable parts.
5. Use only as described in this manual. **DO NOT** use the vacuum for any purpose other than those described in this manual.
6. With the exception of the filters and dust cup, **DO NOT** expose any parts of the vacuum to water or other liquids.
7. Keep the appliance and its cord out of reach of children. **DO NOT** allow the appliance to be used by children. **DO NOT** allow to be used as a toy. Close supervision is necessary when used near children.

GENERAL USE

8. This appliance can be used by persons with reduced physical, sensory, or mental capabilities or lack of experience and knowledge if they have been given supervision or instruction concerning use of the appliance in a safe way and understand the hazards involved. Cleaning and user maintenance shall not be made by children.
9. Always turn off the vacuum before connecting or disconnecting any current carrying hoses, motorized nozzles, chargers, batteries, or other electrical or mechanical parts.
10. **DO NOT** handle plug or vacuum with wet hands.
11. **DO NOT** use without dust cup and pre-motor filter in place.
12. Only use Shark® branded filters and accessories. Failure to do so will void the warranty.

13. **DO NOT** put any objects into nozzle or accessory openings. **DO NOT** use with any opening blocked; keep free of dust, lint, hair, and anything that may reduce airflow.
14. **DO NOT** use if nozzle or accessory airflow is restricted. If the air paths become blocked, turn the vacuum off. Remove all obstructions before you turn on the unit again.
15. Keep nozzle and all vacuum openings away from hair, face, fingers, uncovered feet, or loose clothing.
16. **DO NOT** use if vacuum is not working as it should, or has been dropped, damaged, left outdoors, or dropped into water.
17. Use extra care when cleaning on stairs.
18. **DO NOT** leave the vacuum unattended while powered on.
19. When cleaning carpet, keep the vacuum moving over the carpet surface at all times to avoid damaging the carpet fibers.
20. **DO NOT** place vacuum on unstable surfaces such as chairs or tables.
21. **DO NOT** use to pick up:
 - a) Liquids
 - b) Large objects
 - c) Hard or sharp objects (glass, nails, screws, or coins)
 - d) Large quantities of dust (including drywall, fireplace ash, or embers). **DO NOT** use as an attachment to power tools for dust collection.
 - e) Smoking or burning objects (hot coals, cigarette butts, or matches)
 - f) Flammable or combustible materials (lighter fluid, gasoline, or kerosene)
 - g) Toxic materials (chlorine bleach, ammonia, or drain cleaner)
22. **DO NOT** use in the following areas:
 - a) Poorly lit areas
 - b) Wet or damp surfaces
 - c) Outdoor areas
 - d) Spaces that are enclosed and may contain explosive or toxic fumes or vapors (lighter fluid, gasoline, kerosene, paint, paint thinners, mothproofing substances, or flammable dust)

23. Turn off the vacuum before plugging in or unplugging the charger.
24. Turn off the vacuum before any adjustment, cleaning, maintenance, or troubleshooting.
25. Allow all filters to air-dry completely before replacing in the vacuum to prevent liquid from being drawn into electric parts.
26. **DO NOT** modify or attempt to repair the vacuum or the battery yourself, except as indicated in this manual. **DO NOT** use the battery or vacuum if it has been modified or damaged. Damaged or modified batteries may exhibit unpredictable behavior resulting in fire, explosion, or risk of injury.
27. Always turn off this appliance before connecting or disconnecting motorized nozzle or hand tool.

BATTERY PACK

28. The battery is the power source for the vacuum. Carefully read and follow all charging instructions.
29. To prevent unintentional starting, ensure the vacuum is powered off before picking up or carrying the vacuum. **DO NOT** carry the appliance with your finger on the power switch.
30. For BH100 series please use battery pack XBATR520DCEU. For charging, please use charger YLS0251A-U220080.
31. Keep the battery away from all metal objects such as paper clips, coins, keys, nails, or screws. Shorting the battery terminals increases the risk of fire or burns. Under abusive conditions, liquid may be ejected from the battery. Avoid contact with this liquid, as it may cause irritation or burns. If contact occurs, flush with water. If liquid contacts eyes, seek medical help.
33. Battery should not be stored at temperatures below 3°C (37.4°F) or above 104°F (40°C) to maintain long-term battery life.
34. **DO NOT** charge battery at temperatures below 5°C (40°F) or above 40°C (104°F). Charging improperly or at temperatures outside of the specified range may damage the battery and increase the risk of fire.
35. Store the appliance indoors. **DO NOT** use or store it below 3°C (37.4°F). Ensure the appliance is at room temperature before operating.

36. **DO NOT** expose the battery to fire or temperatures above 265°F (130°C) as it may cause explosion.
37. Use appliances only with specifically designated battery packs. Use of any other battery packs may create a risk of injury and fire.
38. Disconnect the battery pack from the appliance before making any adjustments, changing accessories, or storing appliance. Such preventive safety measures reduce the risk of starting the appliance accidentally.
39. If the charging cord plug does not fit fully into the outlet, reverse the plug. If it still does not fit, contact a qualified electrician. **DO NOT** force into outlet or try to modify to fit.
40. To reduce the risk of shock and unintended operation, turn off power and remove the Li-Ion battery before servicing.
41. Unplug the power cord from outlet when not in use and before servicing.
42. Do not unplug by pulling on cord. To unplug, grasp the plug, not the cord.
43. Turn off all controls before unplugging.
44. The product's power supply cord should be directly plugged into an electrical outlet. Extension cord should not be used.
45. The length of the power supply cord provided on the product is 1.2 meters.

SAVE THESE INSTRUCTIONS

LI-ION BATTERY

Prior to first use, charge the battery completely. A full charge takes approximately 4.5 hours.



RUNTIMES PER FULLY CHARGED BATTERY

BH100 series, with a full charge, will have up to 40 minutes of runtime. Visit sharkclean.co.uk/support online for more information.

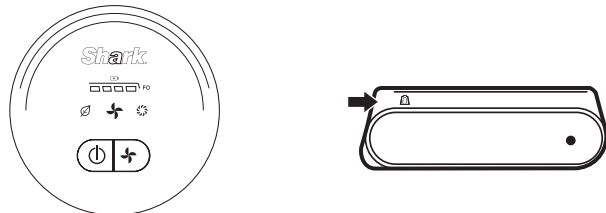
LED BATTERY POWER AND CHARGING INDICATORS



Charging

-  LED on the battery pack will pulse yellow when reaching 0-75% charge.
-  LED on the battery pack will pulse green from 75% - 100% charge.
-  LED on the battery pack will turn white when battery is fully charged.

NOTE: Full charge takes approximately 4.5 hours.

Additional Notes

1. When the battery is fully charged, the LED will turn white, then shut off.
2. Unit will not power on when charger is connected.

In Use

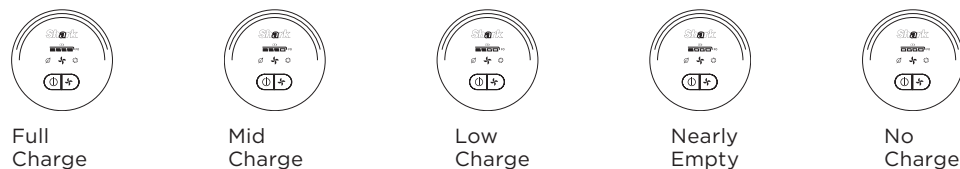

RECYCLING THE LI-ION BATTERY

When the Shark® Li-ion battery needs to be replaced, dispose of it or recycle it in accordance with local ordinances or regulations. In some areas, it is illegal to place spent lithium-ion batteries in the trash or in a municipal solid waste stream. Return spent batteries to an authorized recycling center or to the retailer for recycling. Contact your local recycling center for information on where to drop off the spent battery.

NOTE: The Shark battery, like all lithium-ion batteries, will naturally decrease in capacity over time from the 100% capacity of a new battery.

NOTE: The main unit comes with a partial charge. For maximum runtime, charge fully before first use (approximately 4.5 hours). Leaving the unit plugged in will not damage battery life.

CHARGING/BATTERY REMOVAL

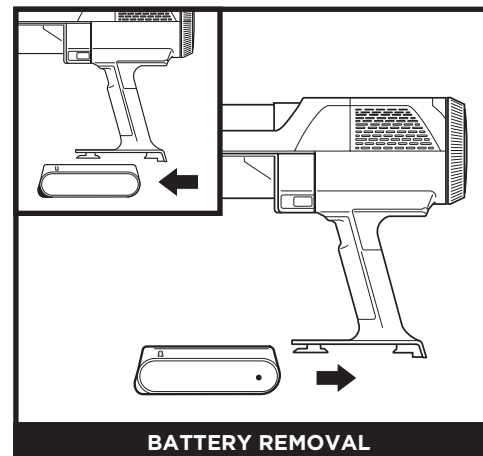

BATTERY REMOVAL

To remove the battery from the hand vacuum, press the release tab on the battery cap and slide out the battery. To reinstall, slide the battery into the compartment in the handle until it clicks into place.

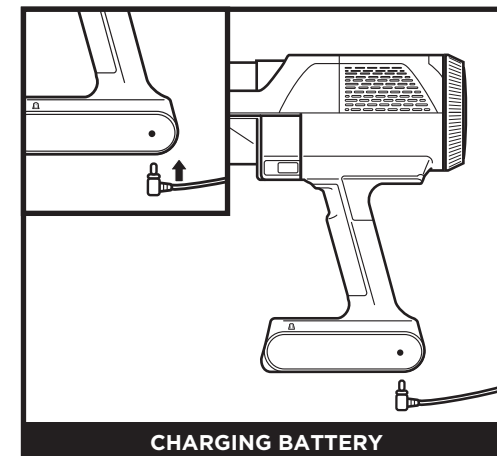

CHARGING BATTERY

To charge the battery, connect the charger to an electrical outlet. Insert the charger plug into the charging port on the battery.

USING YOUR VACUUM

CONTROLS AND CLEANING MODES

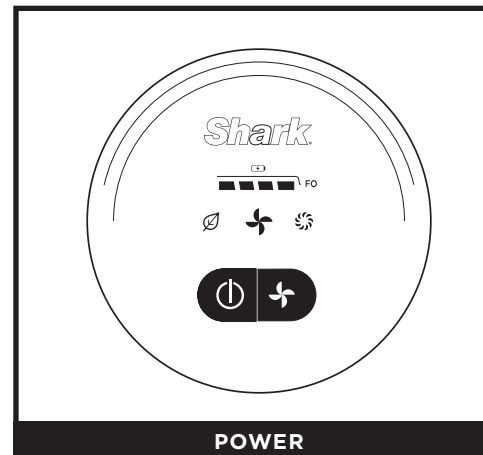

POWER

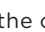
Press the  button on the control panel on the back of the handheld vacuum to turn on power. To turn off power, press the button again. To toggle between ECO, AUTO, and BOOST modes, press the mode selection  button.

MODES EXPLAINED

AUTO mode:
Vacuum runs at an optimized power setting for maintaining battery life and suction performance.

ECO mode:
Vacuum runs on the lowest power setting to preserve battery life. AUTO mode is **NOT** activated in this mode.

BOOST mode:
Vacuum runs at maximum power for the highest possible suction level. AUTO mode is **NOT** activated in this mode.

ATTACHING CLEANING TOOLS

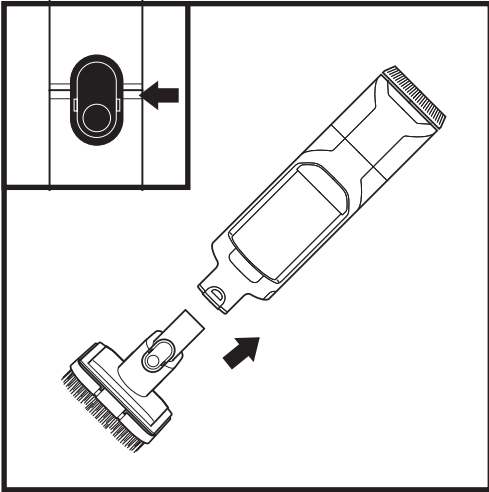

To attach a cleaning tool, slide it into the opening in the nozzle. To remove, press the release button and slide off the tool.

MAINTAINING YOUR VACUUM

CLEANING THE DUST CUP AND FILTER

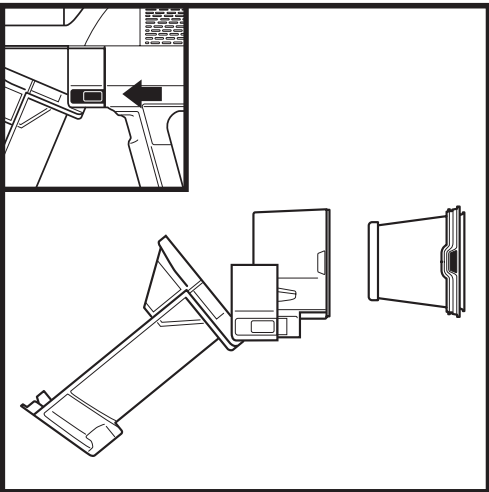

With the dust cup open and the power off, press both release buttons and slide the dust cup out of the hand vac. Press the tabs on both sides of the filter housing and pull the filter out of the housing. To clean the filter, rinse it with water only and allow it to air-dry for at least 24 hours before reinstalling. To reinstall the filter, slide it back into the housing, then slide the housing back into place.

MAINTAINING YOUR VACUUM

EMPTYING THE DUST CUP

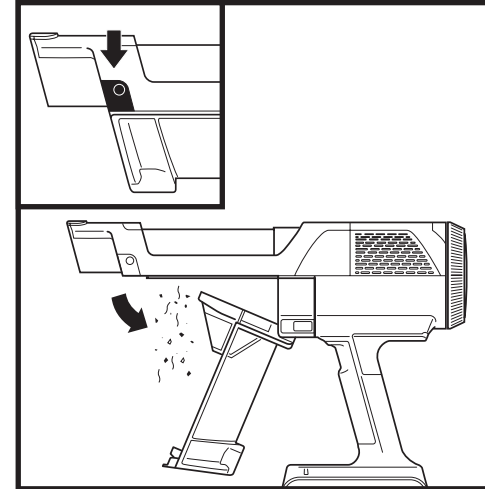

To empty the dust cup, turn off the power and hold the hand vac over the trash. Press the release button and the dust cup lid will drop open, releasing debris.

CHECKING FOR BLOCKAGES IN THE VACUUM

If you pick up a hard or sharp object or notice a noise change while vacuuming, check for blockages.

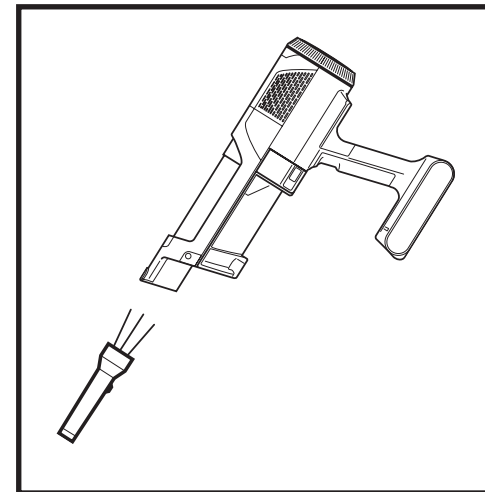

1. Turn off the vacuum.
2. Check all intake openings to the dust cup and remove any debris or blockages.

TROUBLESHOOTING

⚠ WARNING: To reduce the risk of shock and unintended operation, turn off power and remove the battery before servicing.

Vacuum is not picking up debris. No suction or light suction. Third indicator light on hand vacuum is solid yellow. (Refer to Checking for Blockages section for more information.)

1. Dust cup may be full; empty dust cup.
2. Remove any string, carpet fibers, or hair that may be caught on the nozzle or dust cup.
3. Check connection for blockages; clear blockages if required.
4. Check filters to see if they need cleaning. Follow instructions for rinsing and completely air-drying the filters before reinstalling them.

Vacuum lifts area rugs.

1. Make sure you are not engaging BOOST mode. Take care when vacuuming area rugs or rugs with delicately sewn edges.
2. Turn off the unit to disengage from the carpet, then restart.

Vacuum turns off on its own.

There are several possible reasons for the vacuum turning off on its own, including blockages, battery issues, and overheating. If vacuum turns off on its own, perform the following steps:

1. Turn on the vacuum and check the battery indicator lights on the hand vacuum. If recharging is needed, make sure vacuum power is off and recharge the hand vac.
2. Empty dust cup and clean filters (See the Cleaning the Dust Cup and Filter section).
3. Check accessories and inlet openings and remove any blockages.
4. Allow unit and battery to cool for at least 45 minutes, until they return to room temperature.
5. Press the On/Off switch to restart the vacuum.

Battery Indicator Lights on hand vacuum are flashing.

- ECO, BOOST, and 2 Battery lights are flashing (Fig. A): Clog. (See the Maintaining Your Vacuum section.)

Contact Customer Service at

+44 (0)800 862 0453 or sharkclean.co.uk

if you experience any of the indications listed below:

- All LEDs are blinking: critical motor failure. Contact Customer Service. (Fig. B)
- All LEDs except ECO are flashing: Motor is overheating. (Fig. C)
- All LEDs except BOOST are blinking: Critical motor failure. Contact Customer Service. (Fig. D)
- 2 Battery LEDs, ECO, and BOOST LEDs are blinking. Critical motor failure. Contact Customer Service. (Fig. E)
- All Battery LEDs and all mode LEDs are blinking. Motor temperature issue. Clean unit and allow it to sit for 20 minutes. (Fig. F)
- 2 Battery LEDs and BOOST LEDs are blinking: Motor temperature issue. Clean unit and allow it to sit for 20 minutes. (Fig. G)
- 2 Battery LEDs and ECO LEDs are blinking: Critical system failure. Contact Customer Service.



Fig. A



Fig. B



Fig. C



Fig. D



Fig. E



Fig. F



Fig. G

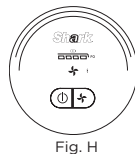

Fig. H

ADDITIONAL ACCESSORIES AVAILABLE ON SHARKACCESSORIES.CO.UK

- A** Crevice Tool
- B** Duster Crevice Tool
- C** Wide Upholstery Tool
- D** Motorized Hand Tool
- E** Pet Multi-Tool
- F** Replacement Battery
- G** Hand Vac Pre-Motor Filter



A

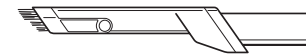

B

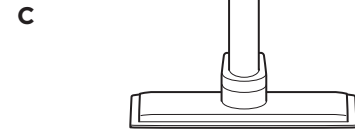

C

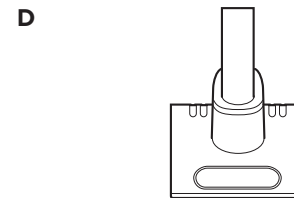

D

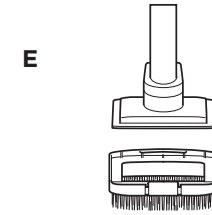

E

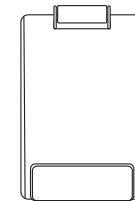

F



G

NOTE: If vacuum still does not operate properly, contact Customer Service at **+44 (0)800 862 0453** or sharkclean.co.uk.

NOTE: Not all accessories come with all units. To order additional accessories, visit sharkaccessories.co.uk.

TWO-YEAR LIMITED GUARANTEE

When a consumer buys a product in the UK, they get the benefit of legal rights relating to the quality of the product (your “statutory rights”). You can enforce these rights against your retailer. However, at Shark we are so confident about the quality of our products that we give you an additional manufacturer’s guarantee of up to two years (1 year as standard plus 1 year when you register). These terms and conditions relate to our manufacturer’s guarantee only - your statutory rights are unaffected.

Every Shark machine comes with a free parts and labour guarantee. Our customer service helpline (0800 862 0453) is open from 9.00am to 6.00pm Monday - Friday. It’s free to call, and you’ll be put straight through to a Shark representative. You’ll also find online support at www.sharkclean.co.uk.

How do I register my extended Shark* guarantee?

You can register your guarantee online within 28 days of purchase. To save time, you’ll need the following information about your machine:

- Model Number
- Serial Number (only if available)
- Date you received the machine (from your in-store receipt or delivery note)

To register online, please visit www.sharkclean.co.uk/register-guarantee

IMPORTANT

- The manufacturer’s guarantee covers your product for 12 months (or for 2 years, if registered) starting on the date of delivery.
- Please keep your receipt at all times. Should you need to use your guarantee (standard 1 year or further 1 year extended) we will need your receipt to verify the information you have supplied to us is correct. The inability to produce a valid receipt may invalidate your guarantee.

How long are new Shark machines guaranteed for?

Our confidence in our design and quality control means that your new Shark vacuum cleaner is guaranteed for a total of two years (12 months plus an extended guarantee of 1 year).

What is covered by the free Shark guarantee?

Repair or replacement of your Shark machine (at Shark’s discretion to decide whether to replace or repair) including all parts and labour. A Shark guarantee is in addition to your legal rights as a consumer.

What is not covered by the free Shark guarantee?

- 1 Blockages - For details of how to unblock your vacuum cleaner, please refer to the Instructions.
- 2 Normal wear and tear of parts which require regular maintenance and/or replacement to ensure the proper functioning of your unit.
- 3 Accidental damage, faults caused by negligent use or care, misuse, neglect, careless operation or handling of the vacuum cleaner which is not in accordance with the Shark Instructions supplied with your machine.
- 4 Use of the vacuum cleaner for anything other than normal domestic household purposes.
- 5 Use of parts not assembled or installed in accordance with the operating instructions.
- 6 Use of parts and accessories which are not Shark spares.
- 7 Faulty installation (except where installed by Shark).

Where can I buy genuine Shark spares and accessories?

Shark spares and accessories are developed by the same engineers who developed your Shark vacuum. You’ll find a full range of Shark spares, replacement parts and accessories for all Shark machines at www.sharkclean.co.uk.

Please remember that using non-Shark spares may invalidate your manufacturer’s guarantee. However, your statutory rights are unaffected.

REGISTER YOUR PURCHASE



sharkclean.co.uk/register-guarantee



Scan QR code using mobile device



RECORD THIS INFORMATION

Model Number: _____

Date Code: _____

Date of Purchase: _____
(Keep receipt)

Store of Purchase: _____

TECHNICAL SPECIFICATIONS

Voltage: BH100 series: 18V

OFF Mode Power Consumption: 0.1W

Benefits of registering your product and creating an account:

- Get easier, faster product support and access to warranty information
- Access troubleshooting and product care instructions
- Be among the first to know about exclusive product promotions

TIP: You can find the model and serial numbers on the QR code label on the bottom of the back of the vacuum pod.

BATTERY REMOVAL AND DISPOSAL

This product uses a rechargeable and reusable lithium-ion battery. When the battery no longer holds a charge, it should be removed from the vacuum and recycled. **DO NOT** incinerate or compost the battery.

When your lithium-ion battery needs to be replaced, dispose of it or recycle it in accordance with local ordinances or regulations. In some areas, it is illegal to place spent lithium-ion batteries in the bin or in a municipal solid waste stream. Return spent battery to an authorized recycling center or to retailer for recycling. Contact your local recycling center for information on where to drop off the spent battery.



NOTES

NOTES

NOTES

© 2025 SharkNinja Operating LLC.

**SharkNinja Europe Limited,
1st/2nd Floor Building 3150,
Century Way, Thorpe Park,
Leeds, LS15 8ZB, UK
+44 (0)800 862 0453,
www.sharkclean.co.uk**

**SharkNinja Germany GmbH,
Rotfeder-Ring 9,
60327 Frankfurt am Main,
Germany
www.sharkclean.eu**

SHARK is a registered trademark of SharkNinja Operating LLC.
Printed in China.
Illustrations may differ from actual product.